



# Important!

Please give copies to all  
your VW Technicians

# Technical Bulletin

Subject: Flexible Fuel (FF) Sensor -G133-, Replacing (B5)

Group: 20

Number: 05-02

Model(s): Touareg V10 (Eng Code BKW)

2004

Date: Aug. 15, 2005

**Instructions:** Perform this procedure on all applicable vehicles within the Limited New Vehicle Warranty



### Tip:

*This Technical Bulletin is in effect for 12 months from date of publication as listed above. After that date, this Technical Bulletin will expire and no longer be in effect.*

### Service

Replace Flexible Fuel Sensor -G133- and re-prime fuel system.

### Requirements:

Vehicle must meet ALL of the following criteria.

- 1 - Procedure is valid only for vehicles that show the B5 code in the OTIS View Campaign inquiry screen on the day of repair (see Page 4).
- 2 - Vehicle must be within the Limited New Vehicle Warranty.
- 3 - Procedure must be performed within the allotted time frame stated in this Technical Bulletin.



### Tip:

*Procedure must also be performed on applicable vehicles in Dealer inventory.*



# Important!

Please give copies to all your VW Technicians

# Technical Bulletin

## Procedure:

Replace the flexible fuel sensor -G133- as follows:

### WARNING

***FIRE HAZARD! When working on fuel systems, Do NOT smoke or work near heaters, open flame, sparks or anything that can ignite fuel or fumes.***

***Prior to working on the fuel system, ALWAYS review fuel related Warnings and Cautions in Group 20 of the Repair Manual.***

- Disconnect fuel supply and return hose from fuel filter housing (see Repair Manual Group 20 *Fuel supply*, Fuel filter, assembly overview).
- Connect suction pump VAS 5226 to water drain connection.
- Loosen sealing plug of water drain and operate suction pump until fuel no longer flows out.
- Tighten sealing plug of water drain to 3 N.m (26.6 in.lbs.).
- ◀ - Remove fuel filter housing -1- (see Repair Manual Group 20 *Fuel supply*, Fuel filter, assembly overview).
- Replace Flexible Fuel Sensor -G133- item -2- with Part No: 07Z 907 666B and tighten fasteners to 3 Nm (26.6 in. lbs.).

### Tip:

*Part numbers listed in this bulletin are for reference only. Always check with your Parts Dept. for the latest parts information.*

- Install fuel filter housing (see Repair Manual Group 20 *Fuel supply*, Fuel filter, assembly overview).

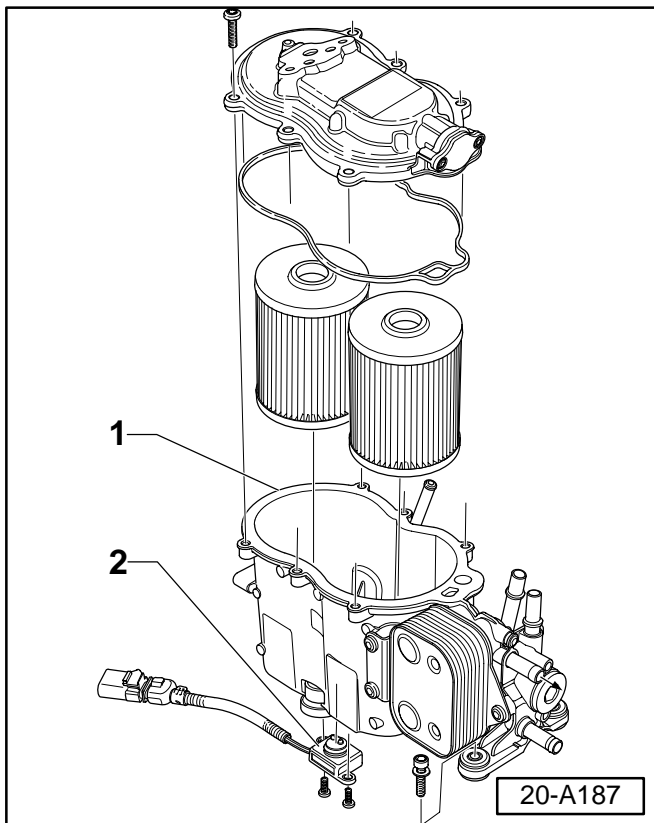



## Important!

Please give copies to all  
your VW Technicians

# Technical Bulletin

---

- Connect fuel supply and return hose from fuel filter housing (see Repair Manual Group 20 *Fuel supply*, Fuel filter, assembly overview).



### Note:

**DO NOT Start Vehicle!** Failure to follow fuel system priming procedure may damage fuel pump.

Prime fuel system as follows:

- Connect the VAS 5051 or 5052 Diagnostic tool.
- Select Address 31; engine electronics
- Select address 04; Basic settings
- Go to MVB: 35
- Select Activate.



### Tip:

*By selecting Activate, the fuel pump should begin to run for 30 seconds and purge any trapped air from fuel system. This activation should be performed 3 additional times, for a total of 2 minutes to totally purge any trapped air.*



# Important!

Please give copies to all your VW Technicians

# Technical Bulletin

## Required Vehicle Update Technical Bulletin Time Requirements/ Reimbursement

To ensure prompt and proper payment, be sure to enter, immediately upon completion of the repair work, the applicable reimbursement code listed below. Claims will only be paid for vehicles that show the B5 code in the OTIS View Campaign inquiry screen on the day of repair.

### B5 Data Entry Procedure Use Claim Type RC

Repair Code (Damage Code Field)	Time Units	Work Scope
B5 12	155 T.U.	Replace flexible fuel sensor -G133- on filter housing and purge air from fuel system.
<b>There is <u>NO</u> Reimbursement for Vehicle Wash or Loaner Vehicle</b>		

The system automatically enters parts and labor applicable to the above listed code.

For vehicles that, according to your information, cannot be corrected or reached, and one of the codes below best describe the reason, please enter one of the applicable codes into the system:

- B5 20 Customer Refused Repairs
- B5 30 Total Loss
- B5 40 Vehicle Stolen
- B5 50 Vehicle Exported

## Additional Required Vehicle Update Technical Bulletins

Some of the affected vehicles may be involved in additional Required Vehicle Update Technical Bulletins. Please check your OTIS View Campaign inquiry screen so that any additional required work can be done simultaneously.

## Required Vehicle Update Technical Bulletin Verification

For verification, **always** check the OTIS View Campaign inquiry screen. The OTIS system is the **only** binding inquiry and verification system; other systems are not valid and may result in non-payment of a claim.

## Help for Claim Input

**For questions regarding claim input, contact your appropriate Warranty Claim specialist.**

Please do not contact the Campaign Helpline regarding claim input.

## Required Customer Notification

**Inform your customer in writing by recording on the Repair Order any and all work that was conducted on the vehicle, including any and all updates completed under this Technical Bulletin.**