

sector 111

READ FITTING INSTRUCTIONS IN FULL BEFORE INSTALLATION

This article is sold without warranty expressed or implied. No warranty or representation is made as to this product's ability to protect the user from injury or death. The user assumes that risk. The effectiveness, warranty and longevity of this equipment are directly related to the manner in which it is INSTALLED, USED, and/or MAINTAINED. THE USER ASSUMES THE RISK.

By purchasing this product and opening the packaging, purchasers expressly acknowledge, understand and agree that they take, select and purchase these SECTOR 111 products from SECTOR 111, its affiliates, distributors, and agents (collectively, SECTOR 111) "as is" and "with all faults".

The entire risk as to the quality and performance of these SECTOR 111 parts is with the purchasers. Working on your car can be a dangerous activity. If you are unsure of what you are doing, please leave mechanical or Safety critical work to a skilled mechanic.

We take no responsibility for the incorrect use and/or installation of SECTOR 111 products.

LIDbone™ Installation Instructions

Supplied Parts:

- 4 Aluminum LIDbone components
- 3 bolts and locking nuts
- 6 large washers and 2 small washers

Tools needed:

- 4mm and 5mm Allen wrenches
- 10mm socket and wretched
- Thread locker (e.g. Loctite)

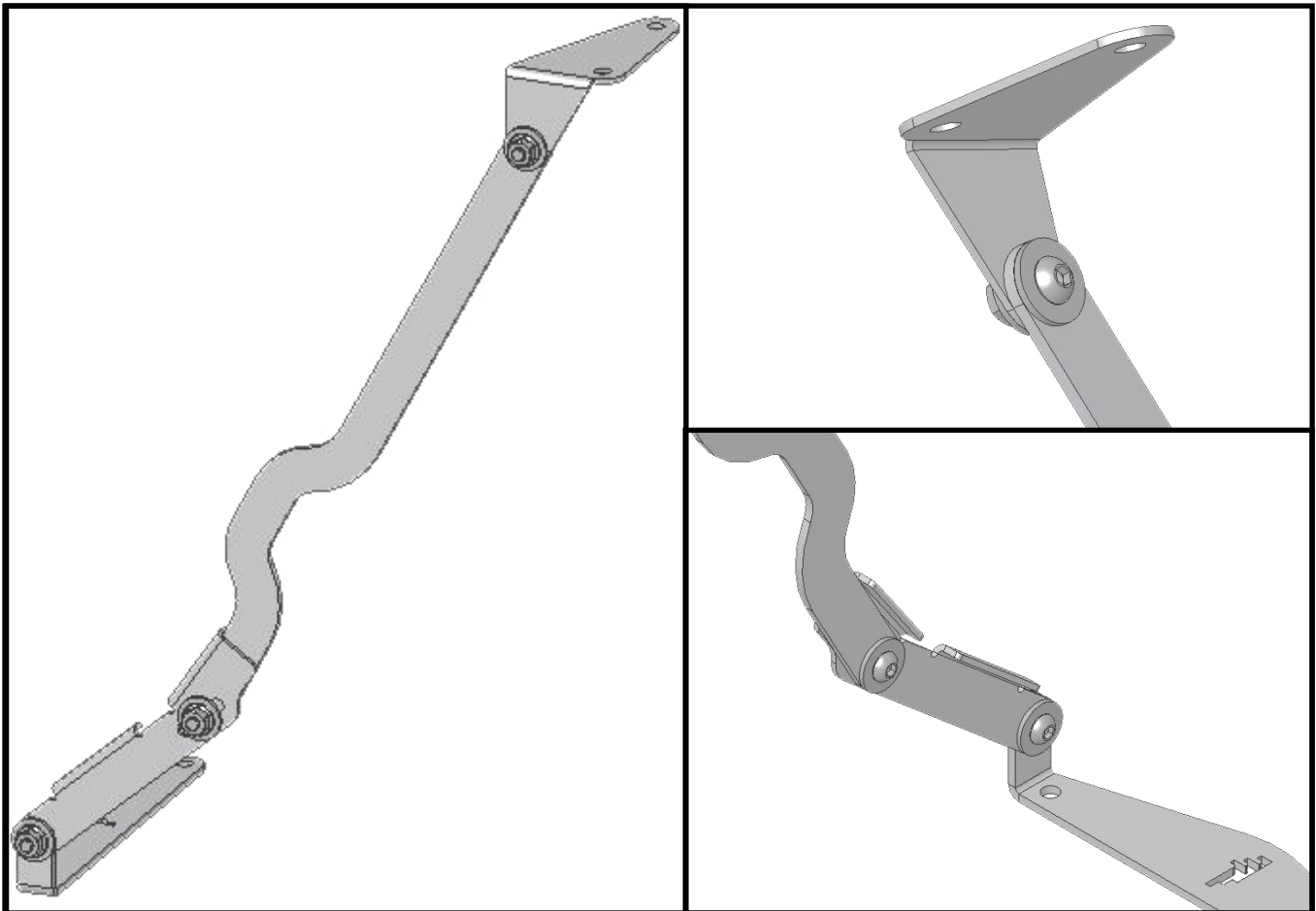

1) Using supplied bolts, large washers, and nuts, assemble kit as shown in the images above. DO NOT overtighten the bolts and nuts. In fact, the bolts, nuts and washers should be fairly loose such that the mechanism easily rotates and moves. Tighten just enough so that the arms swing easily. The nuts self lock and do not need to be tightened to stay in place.

2) Open trunk lid and hold open using factory prop. Attach engine cover bracket using stock allen bolts and the 2 small washers included in this kit. Place small washers between LIDbone bracket and engine cover so that the LIDbone bracket lies flush on the engine cover.

Note: You might want to use medium-strength (serviceable) thread locker on engine cover bolts to prevent bolts from loosening under engine vibration.



3) Remove stock 10mm nuts holding trunk locking mechanism on the underside of the engine lid (image 3A). Release stock lid prop and lift engine lid near to its top limit (close to the roll bar cover). Fit top of LIDbone on trunk lid studs and secure using stock 10mm nuts (image 3B). We recommend using medium or full strength thread locker to secure these nuts.

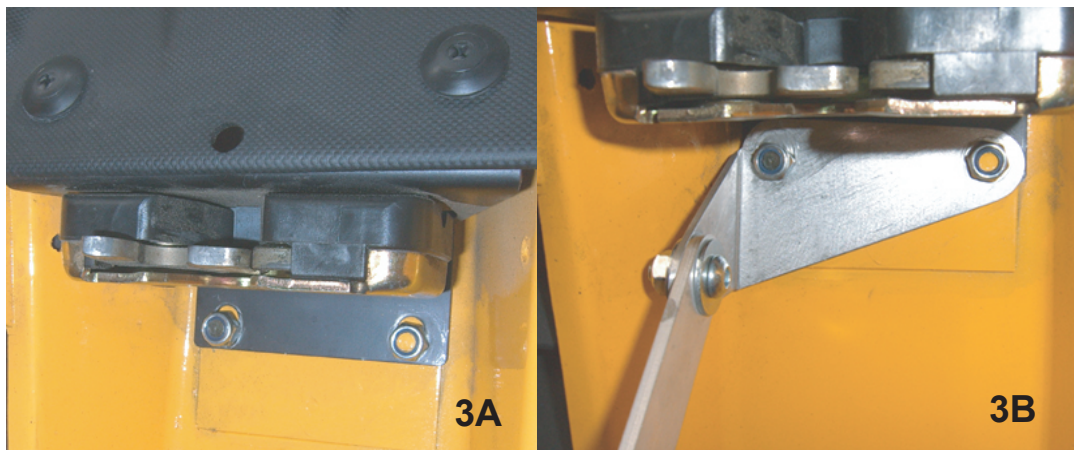

4) The LIDbone will automatically lock in place when trunk lid is opened. To close the trunk lid, hold lid with one hand, and push LID bone towards passenger compartment with other hand until locking mechanism releases. If motion is too stiff or too loose, you can adjust allen bolts and nuts on hinges accordingly until motion is smooth. **Make sure LIDbone is installed as shown in image below.** Enjoy!

